

[bayfieldhallsculpture.com](http://bayfieldhallsculpture.com)

# Bayfield Hall Sculpture Trail 2024

18<sup>th</sup> Sept  
- 20<sup>th</sup> Oct



# BAYFIELD 2024

Bayfield Hall



Sculpture  
Trail

Welcome to our 3rd Sculpture Trail at Bayfield Hall featuring work by 35 artists from the UK, France and Norway. Artists have created artworks for the beautiful gardens at Bayfield Hall with a wide range of approaches, ideas and materials.

“I believe our job as artists is to keep making things and sharing our personal visions of the world. By sharing our inspiration and joy throughout our communities we aim to give people an uplifting experience and other ways of looking at the worlds together. I look forward to welcoming visitors to experience the exceptional artworks created by artists specifically for Bayfield.

Please take care as you walk the trail as some of the ground is uneven. Please treat the artworks with care as some have sharp edges and are fragile. Enjoy your visit, tell your friends and visit us again soon!

Curator, Sarah Cannell.



(Front cover image - Dom Cooper)

Below - Hidden Treasure - Golden Jackalopes at Bayfield Hall



# ARTISTS 2024



**1 ARNIE BARTON** - Bear - made from long needle pine tree from West Beckham, £2600. Spirit of the Cedar Root - wood sourced from West Runton, £1500. Norfolk Totem Pole - sweet chestnut from Broadland country park near Norwich, £1500. You can find Arnie working on the edge of Felbrigg woods A148. [www.roadsidecarver.com](http://www.roadsidecarver.com)



**2 DOM COOPER** - Guardian At The Border - The sculpture is a reminder to look after ourselves and our loved ones, to keep an eye out for mental stress and dissociation. It can be seen as two halves: a calm curving half that suggests a healthy mind, and a spikier one, perhaps angrily at odds with the world. The front, similarly, contrasts with the back - smooth and rounded compared to undulating and distorted. It stands at the border of mental stability and instability. Ancaster Limestone, £1500.



**3 GRACE ADAM - Meteorites** - A series of strange entities has landed on the lawn at Bayfield Hall. Constructed from straw these biomorphic objects are tightly bound with coloured thread. They sit in the grass waiting.



**4 JEN FOX** - Unfold, Uncover, Fold, Turnover  
(an installation of small box forms)

A folded item is sacred somehow, can be shared, opened or closed and contained.

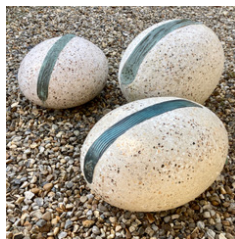

**5 GORDON SENIOR** - Within these boulder like forms are bronze inplants that hold images of arable plants to be found here in Norfolk. £1495 per boulder.

# ARTISTS 2024



**6 SARAH CANNELL** - 'Talisman - An object that is thought to have magic powers and to bring good luck..' Inspired by the Iceni offering talismans to the rivers and land throughout East Anglia, three Jackalopes are released into the grounds every day of the trail. Will you be lucky enough to find one? Ceramic with gold lustre. [www.sarahcannell.com](http://www.sarahcannell.com)



**7 IMI MAUFE** - Going NoWhere, Aluminium. Signage and symbols used to navigate air, land and sea are a common theme in Maufe's work, and this piece combines a selection of recognisable visual information and directional arrows with a twist leading nowhere. £350 each.



**8 ANDY MAULE** - Tipping Point - £800. I have become increasingly concerned with human impact on the environment, and the wider planetary consequences. "Tipping Point", articulates the fragility of our current condition while referencing its connection to our industrial past through the use of an archaeological fragment of a mill stone as a base. Wire Figure at box office £750.



**8a PETER DAY** - Bella Ballerina 2024 - a tribute to the late Cecil Morris and his work cultivating the Benton End Irises. Mild steel on stone plinth £4740.



**9 SONIC MOTH** - Sound installation with imagery from Pakefield Beach.

**9a NICK BALL** - GORT - represents the need to clean up our planet, ironically made from a waste product which itself is made from an endangered species. Cork figurehead.

**10 BETH GROOM** - Working playfully and intuitively with disused organs pipes, this new body of work considers ideas about the history and meaning of making with found objects. Beginning with the personality and presence of these austere hollow grey objects the work wittily and thoughtfully reframes the subject in a way that is at once intriguing and ambiguous.

# ARTISTS 2024



**11 PAEONY LEWIS - BELIEF.** Where does belief begin and end? Votives hang above crates containing cameraless photographs of ripples in bottles, created from water collected at ancient wells, imbued with centuries of belief. Can belief be bottled?



**12 JEAN KIEKOPF - Craning Cranes -** A sway in the breeze; a whisper through the grass or reeds - these elegant cranes tower gracefully in all seasons. Jean Kiekopf has created these 'Craning Cranes' from steel rods, cassini plaster and Powertex. They are suitable for indoor or outdoor display. £145 each.



**13 ESTHER BOEHM - After The End -** £1850. Through a recent orchard project, I painted branches white — transforming them — exposing the purity of their form. This inspired the whimsical aspect of my white sculptures. Commission taken.

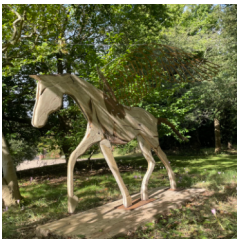

**14 CINDY LEE WRIGHT - The Horse with Wings –** I always called a winged horse Pegasus because I didn't know any better. I now know he is universal and has so many names, perhaps ours is from Islam? Then he would be called Haizum– the horse given to the Archangel Gabriel. Or maybe he is Devadatta, from Hinduism, or Tianma from China, or Tulpar, Al-Buraq, The Wind Horse, then of course, he may be Fledge, from Narnia. £2750.



**15 LOUISE KOSINSKA - Blue bottle, green bottle, blue grass, green grass.** Blue bottles arranged in a sinuous form, filled with water collected from rain and dew reference my continued love of blue and glass but also the ten green bottles standing on the wall, recycling ,repurposing and bluebottles which have a bad rep but provide important benefits to the ecosystem.

# Cafe / Toilets

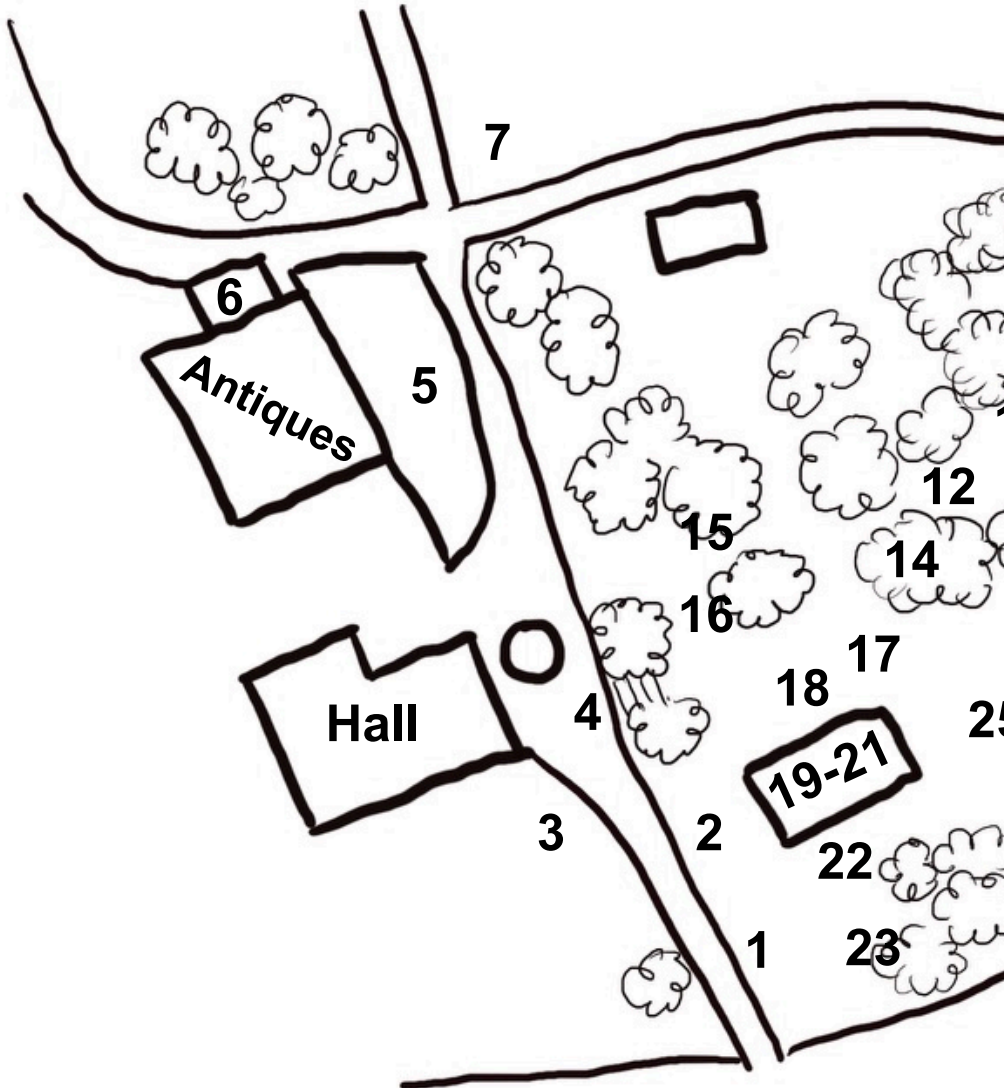

# Parking / Exit

Each artwork has a numbered post next to it with a pink painted top. For more information about each artist in this guide and navigate your way

For your own safety please treat the artworks with care and supervise children. Artworks are fragile. The paths are uneven in places. There are mole tunnels, nettles and other plants at the cafe. Dogs on leads welcome, please clear up after them. To exit

# TRAIL MAP 2024

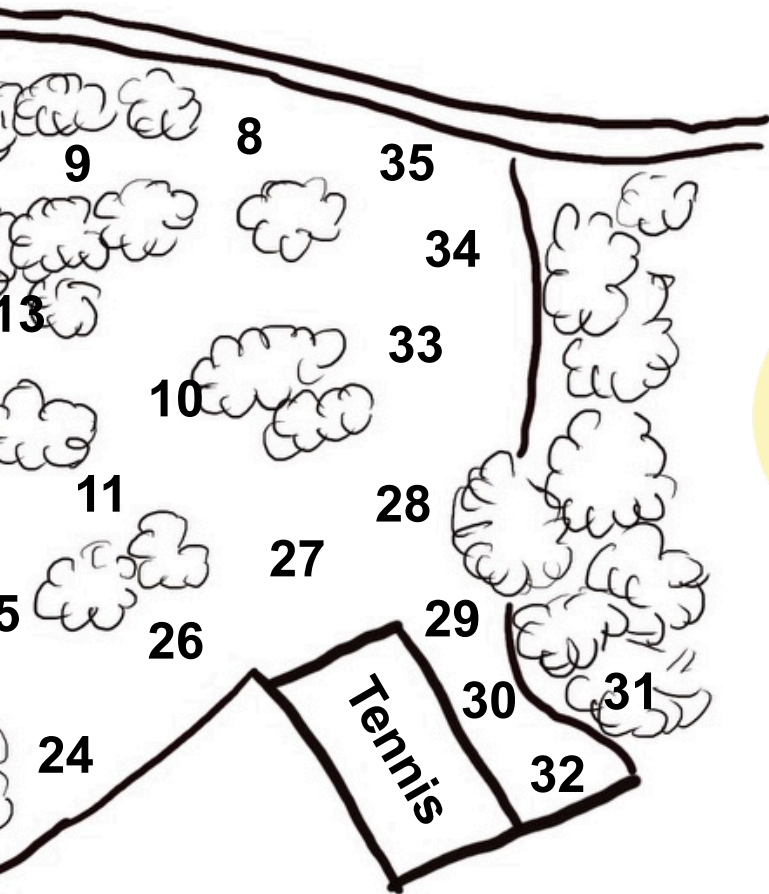

Follow the numbers in order to make sure you don't miss any. Get  
y through the trail using the map above.

Children at all times. Some sculptures have sharp edges or are  
and some tree roots so please watch your step. Toilets are located  
it drive through the park to the south gate. Thank you for visiting :)

# ARTISTS 2024



**16 HELEN BREACH** - A collection of abstract metal sculptures assembled from discarded agricultural implements & machinery from Aunt Rosemary's barn. Aunt Rosemary was born and lived in the same farmhouse all her eighty-five years. When clearing the barn, metal items were collected and it's my privilege to reuse them in a creative form in memory of an amazing Norfolk character. Prices range £175 - £375, list at box office.



**17 SHAUN PICKERING** - Running Horse, £2850. One of the boldest creatures to emerge from Shaun's forge in Ellingham, South Norfolk. The Running Horse has been made specifically for the site at Bayfield.



**18 ALISON HENRY** - Swifts grace our skies each summer, but their future here is threatened, partly due to loss of suitable nesting sites. In Swifts I-IV the ghostly white of plaster moulds and the blackness of clay tiles reflect my dread that one day we may lose them entirely. Plaster moulds (unique) £450 each. Tiles £100 each.



**19 LAURA CANNELL** - From her recent highly acclaimed album *The Rituals of Hildegard Reimagined* Laura's experimental recorder can be heard filling the ancient chapel at Bayfield and soaring across the valley. You can purchase the album, £14, or stream at [www.brawlrecords.co.uk](http://www.brawlrecords.co.uk)



**20 MANDY CALDON - Queen of Swords** - This piece reflects the vulnerability, strength and spiritual power of our female ancestors, translated in stoneware clay and presented in traditional form. £1500.

# ARTISTS 2024



**21 RACHEL BURCHELL** - Which Path - A reflection on permanence and ephemerality within the precarious climate situation we find ourselves - a reminder of our ongoing need to protect the natural world, promote species stability as well as appreciate the beauty of the hidden and overlooked. Wild flora from Bayfield grounds have been used to create bas reliefs using eco resin.



**22 MONICA WHEELER** - Come Dine with Me - Many of my installations are visually linking the domestic, nature, and animals importance in our everyday lives, for our wellbeing, and deeper understanding of that connection. Perhaps it's a yearning for more of it as I live in London.



**23 CHARLOTTE DICKENS** - Tactile pottery, intended to be interacted with, decorated motifs blended with their living counterparts; do you see a frame, the natural surroundings captured within, or a portal into another realm?



**24 NICCI DEDMAN** - **Pickle £1200.** Inspired by a love of creating with wire and a lifelong love for dogs Nicci creates unique, individual characters. Rosie £1,100 and Bella £1,150 can be seen in the shop. Commissions happily taken. Nicci's work will be on show at top contemporary makers exhibition MADE in London this October.



**25 - REBECCA AMPHLETT** - The Fifth Element - The four outer spheres represent the classical elements: water, fire, earth, and air. At the centre, a golden globe adorned with the "Seed of Life" pattern, symbolising The fifth element, representing the harmony and interconnectedness of all four elements of nature. Green, Earth, £1,250. White & silver Air, £1,250. Red & orange Fire, £1,250. Blue, Water £1,250. Golden 5th element £1,250. All 5 spheres, £5,500.

# ARTISTS 2024



**26 KATE ALLSOP - Earth Mother, Porcelain, handbuilt.** Reclaiming sensuality and connecting with nature. £3,000.



**27 MEG AMSDEN - Three Weird Sisters, human/ spirit, magical/material; Maiden, Mother, and Crone.** Faces of the triple fertility goddess of ancient Europe (aka the Morrigan or Norns) grow from the bark of three birch trees. Cauldron of Plenty £250 (unique piece). Matonae Maidens £300. Matronae Mothers £300. Matronae Crones £300. All edition of 5.



**28 JANE IRONSIDE - Hot Air - From Grenfell to Gaza From Yemen to Ukraine. £250.**



**29 MIKE CHALLIS - Saw Song – A playful use of recycled materials; Sawsong is a sound sculpture using discarded circular saw blades repurposed as gongs. The blades are arranged on threaded rods in a mirrored box and played with ball bearings to create a cacophony of sound.**



**30 KALLY DAVIDSON - Like stories, phobias can be retold within tribes. Not wishing this, I followed threads of a growing curiosity since my maternal grandmother died, into Spider Amore. Sitting with the seasons of life in constant flux, yarns woven in mind from womb fruit to spider star. Price list at box office.**

# ARTISTS 2024



**31 SOPHIE AUSTIN** - Welcome Storyteller, we've been waiting for you. What happens next? Take a seat, open the leather-bound book, read what has been written. Dare you continue the story? An interactive installation inviting you to write what happens next in the story so far. Created by Sophie Austin with soundscape by Isa Suarez. Sophie Austin is a storyteller working across theatre, film and audio to connect us to the wilder world. You can hear how this Bayfield Hall story unfolds here: [www.sophiejaneaustin.com](http://www.sophiejaneaustin.com)



**32 RACHAEL LONG, ANDY JARRETT, SARAH CANNELL - MARSH PONIES** collaboration. The ponies gallop around East Anglia, they have visited Norwich Cathedral, Snape Maltings, Raveningham Sculpture Trail and are spending the Autumn at Bayfield. Commissions taken.



**33 NATHAN JARVIS - Guardian - £14,000. Untitled £14,000.**



**34 RACHAEL BARNES - Encapsulated** - Fragile natural elements held in fused soft plastic circles representing the circle of life, reuse, recycling and a reminder of the natural cycle of life and death. The central pieces hold a collection of site-specific found poems, each referring to a [///what3words](http://www.what3words.com) location in the Bayfield Hall Lake.



**35 MERYEM SIEMMOND - Golden Journey** - Inspired by Japanese Kintsugi, the art of repairing pottery with gold. Even though things may be damaged they are still valuable and have meaning. We have pains, sad stories, as well as good things all of which make us who we are. By embracing flaws we become stronger, everybody can have their own Golden Journey. £1,150.



The Creative Odyssey is the CIC (Community Interest Company) that has developed from the idea that we all need something to work towards and to look forward to which will spread a bit of light and magic, a focus away from the challenges of life with the idea that using simple materials and making art together, celebrating art and nature, will benefit everyone's mental health regardless of what life has thrown at them.

Huge thanks to all the artists for putting so much love, expertise and work into making this trail a magical experience. Thanks to Caroline and Roger Combe for allowing us all to play in the beautiful gardens at Bayfield Hall 2024.

Mandell's Gallery



**ODYSSEY POSTCARDS EXHIBITION** - We are running our third postcard fundraising exhibition for Children with Cancer UK and Creative Odyssey - Arts projects to inspire and soothe the soul. Kindly hosted by Mandell's Gallery, Elm Hill, Norwich. Exhibition and sale of works runs 13<sup>th</sup> - 16<sup>th</sup> November, all works £40. Original artworks have been donated by artists from around the world.

[www.raveninghamsculpturetrail.com](http://www.raveninghamsculpturetrail.com)

For more details about Creative Odyssey and the Postcard fundraiser if you are an artist who would like to donate work or to join our mailing list so you don't miss any inspiring events.